

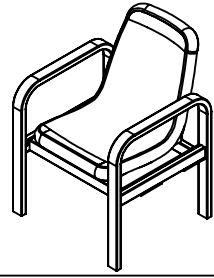

VersaFrame Single Seat Assembly Instructions



Model Number
VFB1-XXX-XXXX

www.norix.com • TEL 800 234-4900

Assembly Notes: Norix is not responsible for any damage due to improper installation. If your shipment does not match the parts list, please contact Norix Customer Service at 800-234-4900. Norix reserves the right to modify design specifications at any time without an obligation to owners of previously sold products.

ITEM NO.	QTY.	PART NUMBER	DESCRIPTION	Tools Needed
1	2	060-313-XX	STEEL FRAME, VERSAFRAME, END ARM	Low RPM Variable Speed Drill
2	1	060-317-XX	STEEL FRAME, VERSAFRAME, SEAT	T-40 Torx® Bit
3	1	040-30XXX	BOULDER SEAT	
4	14	021-001	SCREW, MACHINE 5/16"-18 X 5/8" L, FH, PIN IN TORX® T40, BLACK OXIDE, THD. LK.	
5	6	021-051	SCREW, MACHINE 5/16"-18 X 5/8" L, BH, PIN IN TORX® T40, ZINC, THD. LK.	

STEP 1. Carefully unpack all components and lay them flat on a clean, non-abrasive surface. Confirming that the screw holes are located on just one side of the midrail, position one end arm flat (1), ensuring the screw holes on the midrail are facing upward.

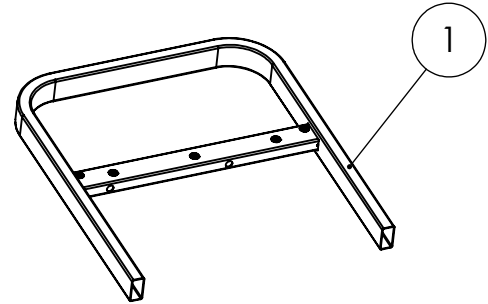

STEP 2. Align the seat frame (2) with the arm midrail on the end arm (1), placing it so that the bent plates are underneath and match the corresponding screw holes. Secure the seat frame (2) to the middle support bar with screws (4), starting with the middle screw and then moving outward. Use 5 screws on the flat face and 2 screws on the underside of the bent plates.

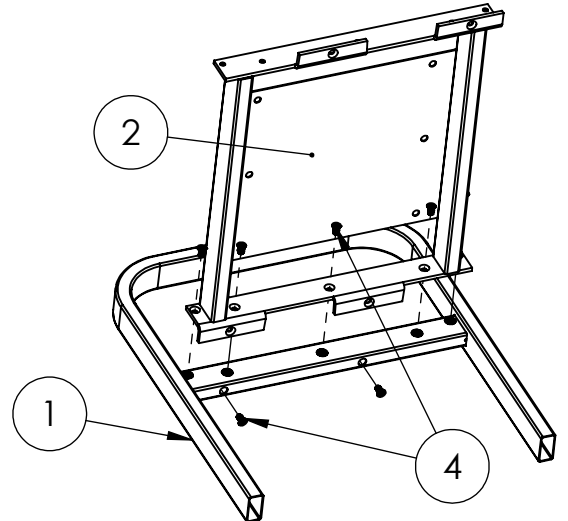

STEP 3. Rotate the two-piece assembly 90 degrees such that the solid tube of the seat frame faces upwards, with the arm now positioned at the side. Repeat Step 2 for the opposite arm (1).

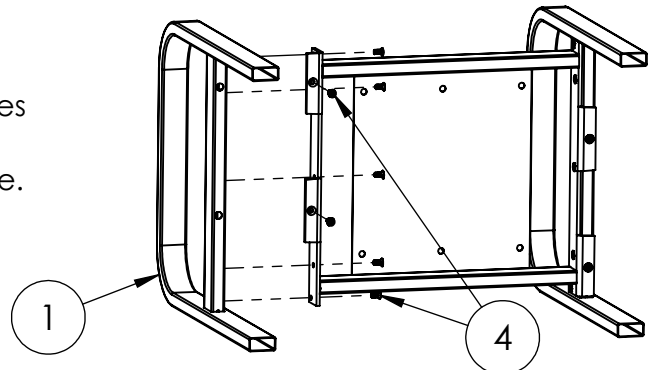



VersaFrame Single Seat Assembly Instructions

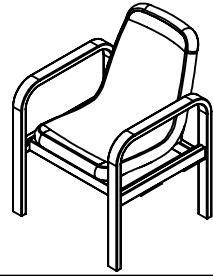

Model Number
VFB1-XXX-XXXX

www.norix.com • TEL 800 234-4900

Assembly Notes: Norix is not responsible for any damage due to improper installation. If your shipment does not match the parts list, please contact Norix Customer Service at 800-234-4900. Norix reserves the right to modify design specifications at any time without an obligation to owners of previously sold products.

STEP 4. Position the molded seat (3) down on the backrest, between the arms. Carefully lift the molded seat to align the holes in the seat with those on the seat frame plate. First, attach the molded seat using screws (6) across the top row. Avoid tightening any screws completely until all screws are in place. Tighten screws while ensuring the underside pocket of the molded seat rests flush against the seat frame plate. Repeat steps 9 and 10 to install additional seats.

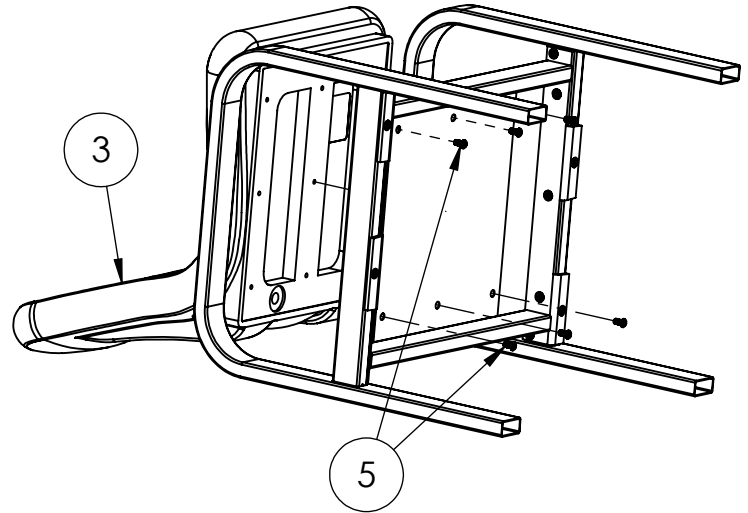

OPTIONAL BRACKET CUFF RING

STEP 1. Determine which corner you want to place the Bracket cuff ring. From your selected corner, remove one screw (5) from underneath the seat (2) and another from the midrail (5). Attach the Bracket Cuff Ring (7), then reinsert the screws you removed to finish the assembly.

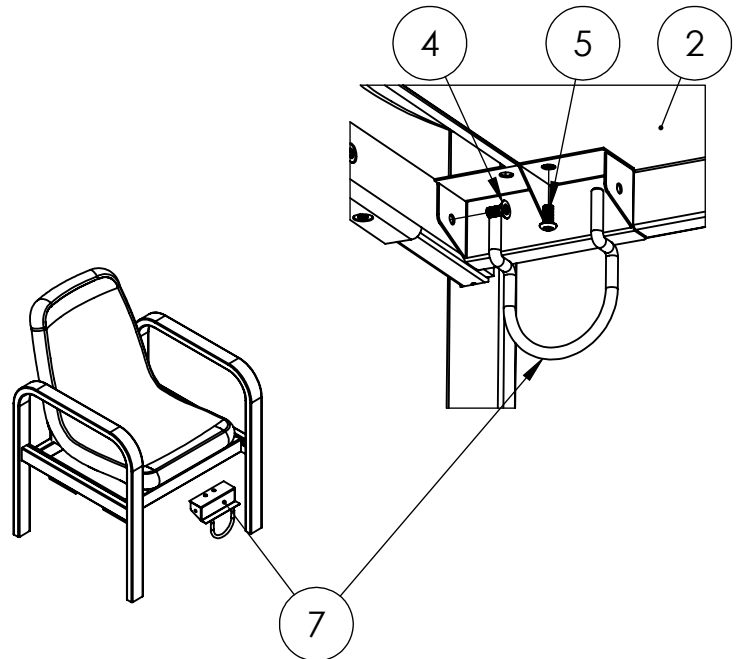

ITEM NO.	PART NUMBER	DESCRIPTION
7	060-318-XX	Bracket Cuff Ring