

## Protege II Bunked Assembly Instructions

See PROT100-XX and Assemle First

**Model Number  
PROT200-XX**

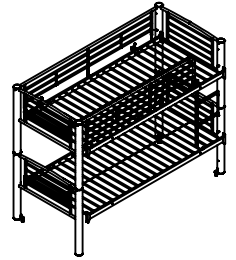

www.norix.com • TEL 800 234-4900

Assembly Notes: Norix is not responsible for any damage due to improper installation. If your shipment does not match the parts list, please contact Norix Customer Service at 800-234-4900. Norix reserves the right to modify design specifications at any time without an obligation to owners of previously sold products.

### PARTS LIST

ITEM NO.	QTY	REV	PART NUMBER	DESCRIPTION
A	4	A	036-PT002-XX	Protege II Vertical Connector
B	1	A	030-PT002-XX	Protege II Long Safety Rail
C	1	A	030-PT003-XX	Protege II Short Safety Rail
D	1	A	036-PT003-XX	Protege II Ladder
E	3	A	021-129	Screw, Machine, 5/16-18 X 4", CH, 5mm Hex Socket, Black Oxide
F	3	A	025-042	Washer, Radius 1-1/2", 3/8" ID x 1-3/16" OD, Black Oxide
G	5	A	021-128	Screw, Machine, 5/16-18 X 2-3/4", CH, 5mm Hex Socket, Black Oxide
H	5	A	025-043	Washer, Flat, 3/8" ID x 11/16" OD, Black Oxide
I	2	A	021-130	Screw, Machine, 1/4-20 X 2-3/4", CH, 4mm Hex Socket, Black Oxide
J	9	A	025-041	Washer, Flat, 1/4" ID x 5/8 OD, Black Oxide
K	1	A	021-134	Nut, Barrel 1/4-20 X.875", 5/16" OD, 4mm Hex Socket, Black Oxide
L	1	A	021-133	Screw, Machine, 1/4-20 X .625", CH, 4mm Hex Socket, Black Oxide
M	2	A	030-PT004-XX	Protege II Wall Bracket
N	2	A	025-044	Nut, Lock, 1/4-20, Black Oxide
O	2	B	021-131	Screw, Machine, 1/4-20 X 2-1/2", CH, 4mm Hex Socket, Black Oxide
P	1	A	071-016	Allen Wrench, 4mm
Q	1	A	071-017	Allen Wrench, 5mm
R	3	A	060-194	Spacer Tube, Protege II 1/2" OD x 3/8" ID x 2-13/16
S	2	A	021-132	Screw, Machine, 1/4-20 X 1", CH, 4mm Hex Socket, Black Oxide

Note: Do not tighten screws until assembly is complete.  
This product requires two people for final assembly

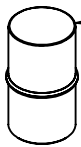

A

036-PT002-XX (4 PCS)

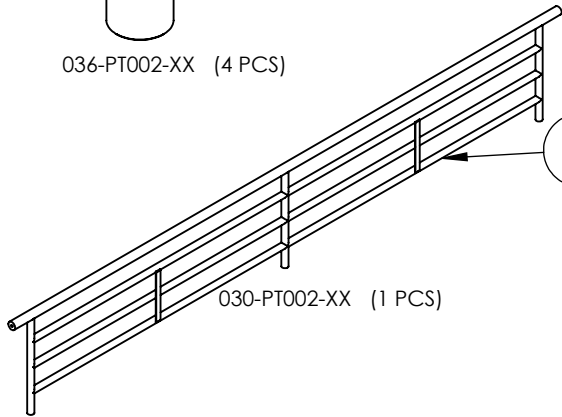

B

030-PT002-XX (1 PCS)

C

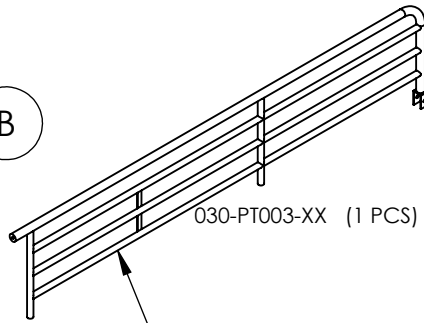

030-PT003-XX (1 PCS)

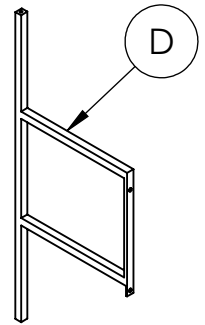

D

036-PT003-XX (1 PCS)



L

0.625

021-133 (1 PCS)



S

1.000

021-132 (2 PCS)



O

2.250

021-131 (2 PCS)



I

2.750

021-130 (2 PCS)



G

2.750

021-128 (5 PCS)



E

4.000

021-129 (3 PCS)



K

021-134 (1 PCS)



R



060-194 (3 PCS)



P



071-016 (1 PCS)



Q



071-017 (1 PCS)

M

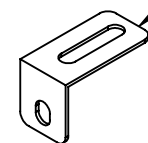

030-PT004-XX (2 PCS)



F

025-042 (3 PCS)



H

025-043 (5 PCS)



J

025-041 (9 PCS)



N

025-044 (2 PCS)

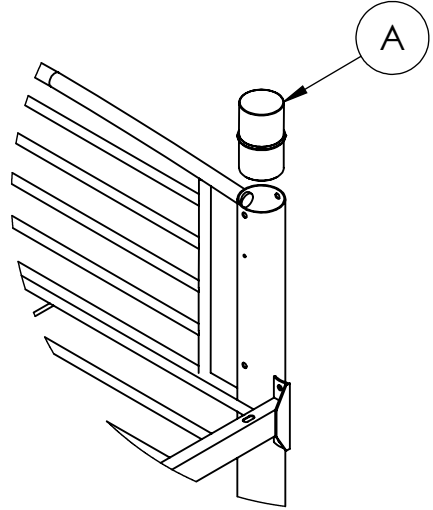
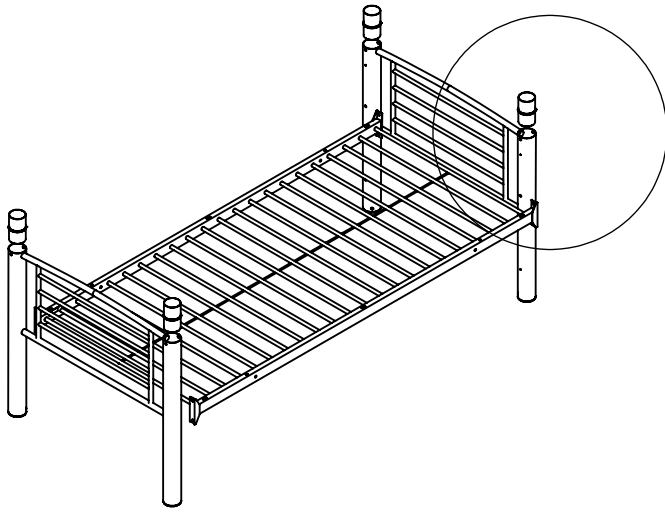

**Step 1:** Install (4) Vertical Connectors (A) into Lower Bunk End Frames.

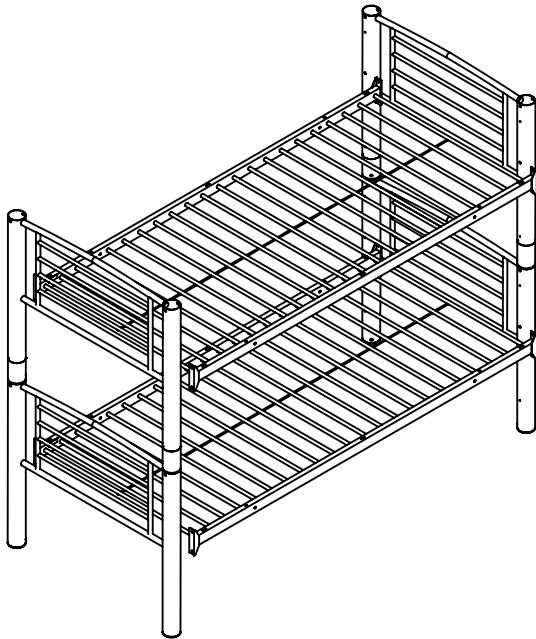

**Step 2:** Stack Upper Bunk

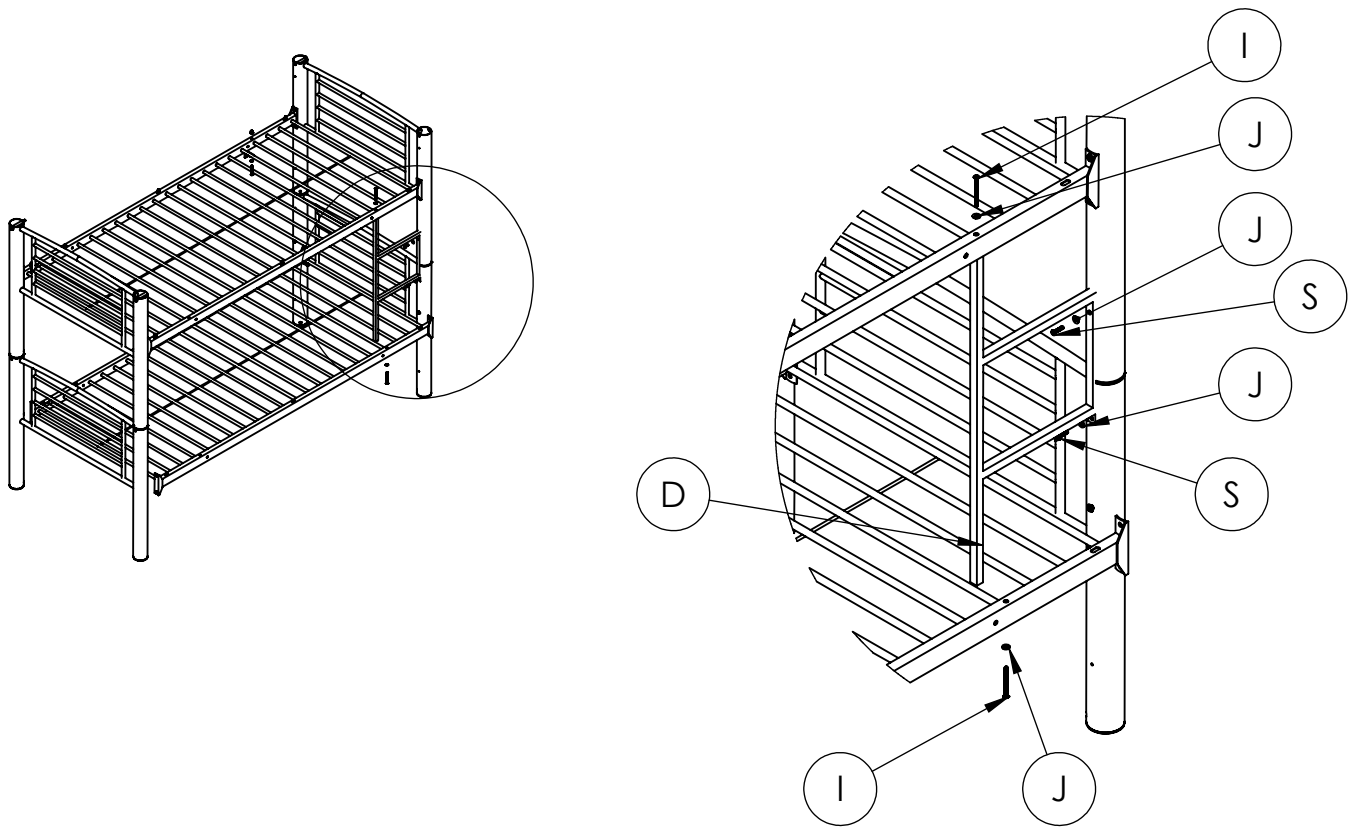

**Step 3:** Determine Ladder (D) Location (Left or Right ) Using (2) 1/4" x 2-3/4" Screws (I) and (2) 1/4" Washers (J) attach vertical Ladder tube to upper and lower Decks (do not tighten) Using (2) 1/4" x 1" Screws (S) and (2) 1/4" Washers (J) attach ladder to End Frame.

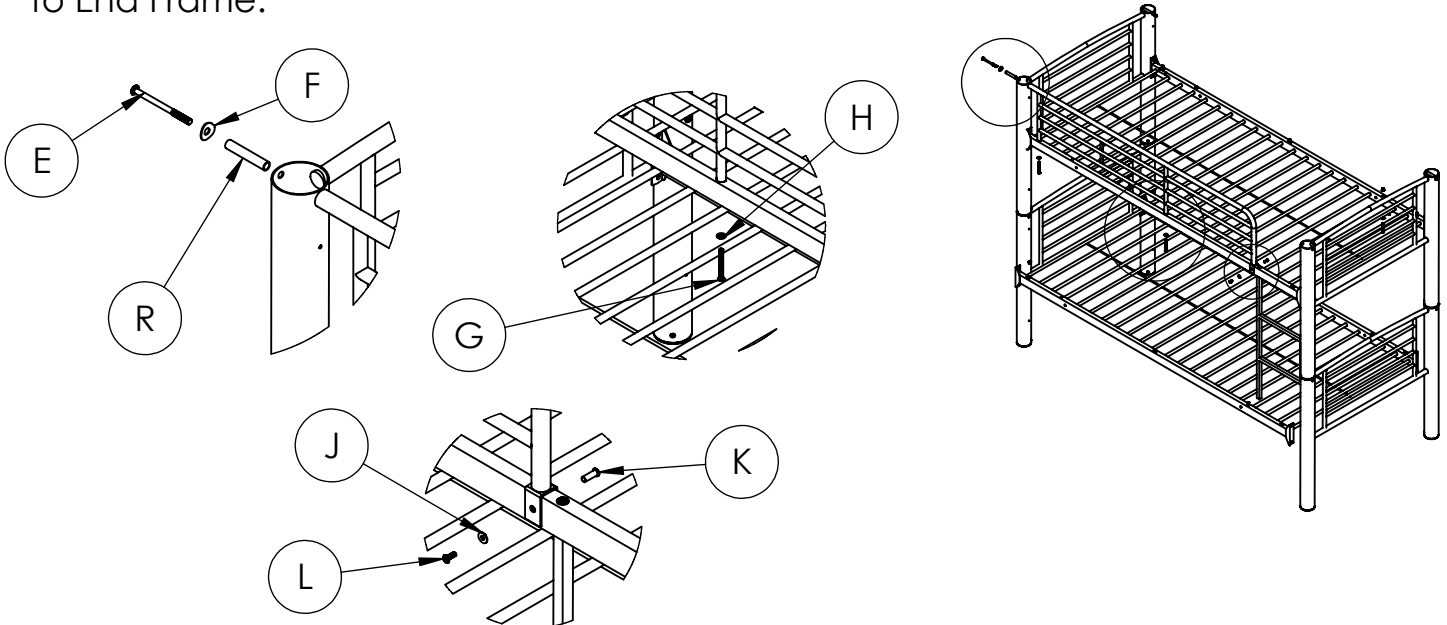

**Step 4:** Using (1) 5/16" x 4" Screw (E), (1) Washer Radius (F), and (1) Spacer Tube (R) fasten Short Safety Rail (C) to End Frame opposite the Ladder. Using (2) 5/16" x 2-3/4" Screws (G) and (2) 3/8" Washers (H) fasten Short Safety Rail vertical tubes to Deck. Fasten front Flange of Short Safety Rail to Deck with (1) Barrel Nut (K), (1) 1/4" Washer (J), and (1) 1/4" x 5/8" Screw (L)

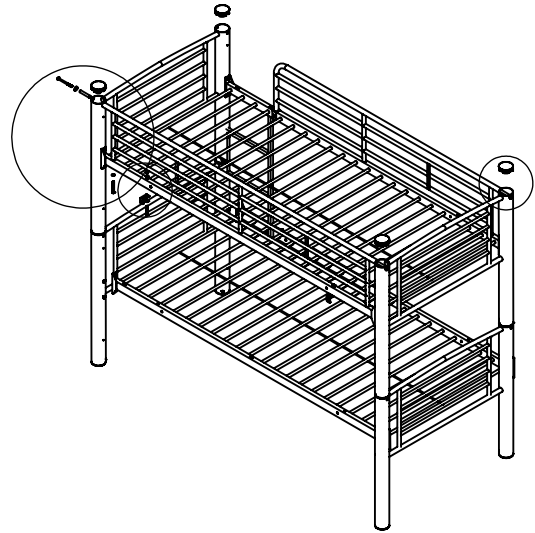
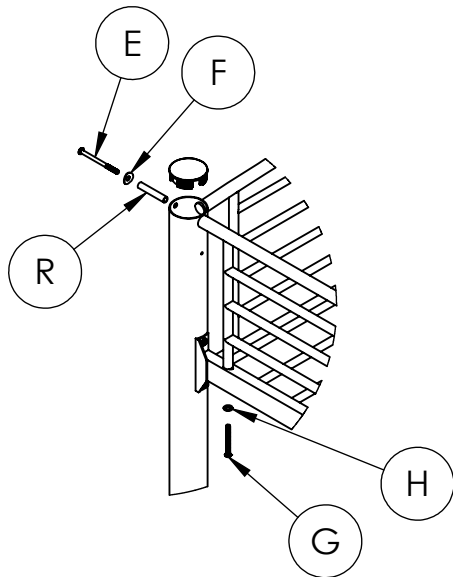

**Step 5:** Fasten Long Safety Rail (B) Using (2) 5/16" x 4" Screws, (2) Washer Radius (F), and (2) Spacer Tubes (R) to End Frames. Using (2) 5/16" x 2-3/4" Screws (G) and (2) 3/8" Washers (H) fasten Long Safety Rail vertical tubes to Deck.

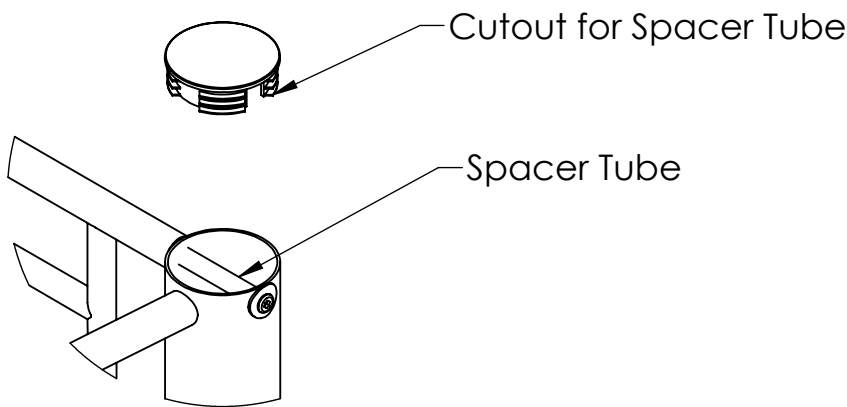

**Step 6:** Insert Tube Caps with Cutout aligned to Spacer Tubes.

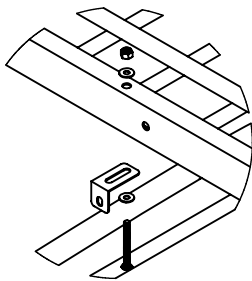

**Step 7:** If Bolting to the wall use (2) Wall Brackets (M), (4) 1/4" Washers (J), (2) 1/4" x 2-1/2" Screws (O), and (2) Lock Nuts (N) and fasten to Top Deck Rail, Two Places.

\*If Bolting to Floor see Instructions for PROT100-XX