

## Recessed ADA Shower Seat Assembly Instructions

Model Number  
ISS-210

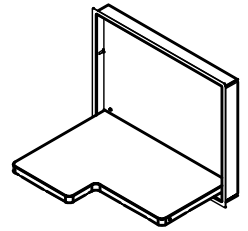

Assembly Notes: Norix is not responsible for any damage due to improper installation. If your shipment does not match the parts list, please contact Norix Customer Service at 800-234-4900.  
Norix reserves the right to modify design specifications at any time without an obligation to owners of previously sold products.

### PARTS LIST

ITEM	QTY	DESCRIPTION
1	1	Wall Mount Assembly
2	1	Folding Seat Assembly
3	4	Socket Cap Screw, SST Btn. Hd., 1/4-20 UNC x 1 1/2
4	1	T27 Torx Insert Bit

Tools Needed  
1/4" Hex Driver

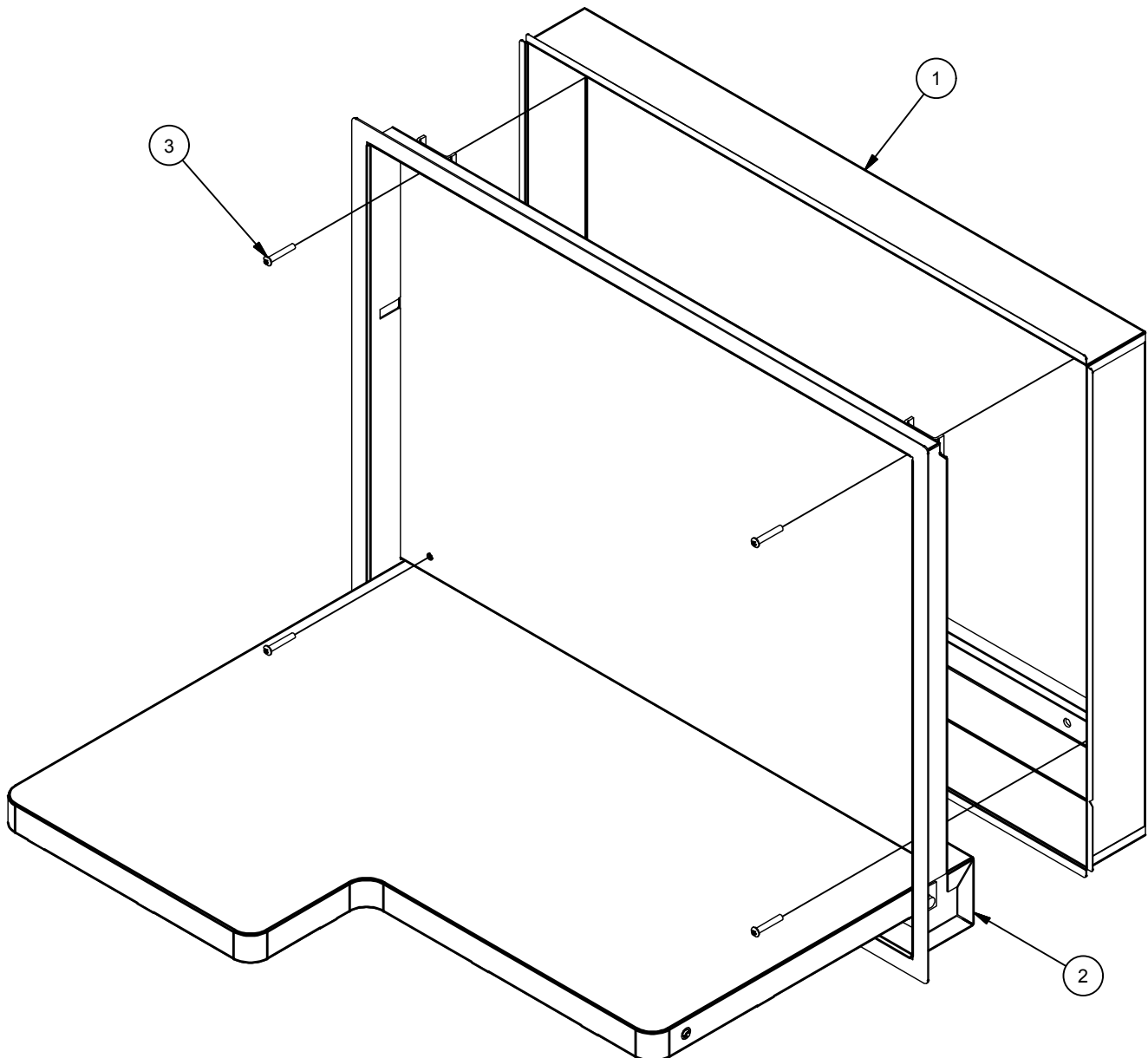

**\*WALL MOUNT ASSEMBLY INFORMATION**  
 Wall Mount Assembly must be securely anchored to supporting wall to function properly. Face must be flush in all cases. For different wall types follow these guidelines.

- 1.) In hollow walls - Ensure secure structural reinforcement when mounting Wall Mount Assembly.
- 2.) In concrete walls - Install at pre-determined location and pour in place.
- 3.) In concrete block walls - Build Wall Mount Assembly into wall and grout into place.

#### OPPOSITE HAND ASSEMBLY INSTRUCTIONS.

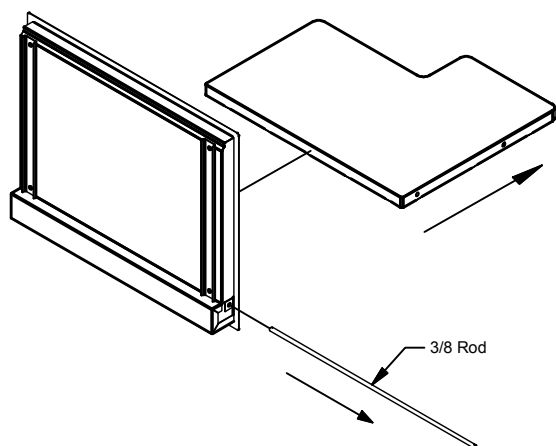

Step 1: Remove 3/8" Rod From Stainless Steel Folding Seat Assembly

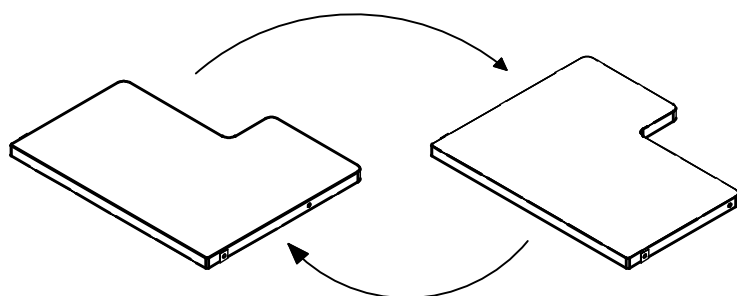

STEP 2: Turn Seat Over To Opposite Side

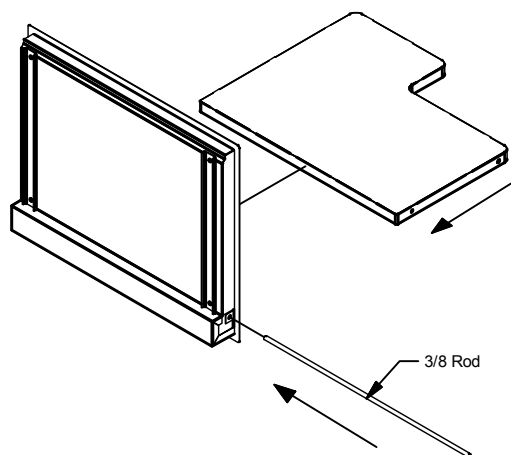

STEP 3: Reinsert the 3/8 Rod through Housing and Seat.

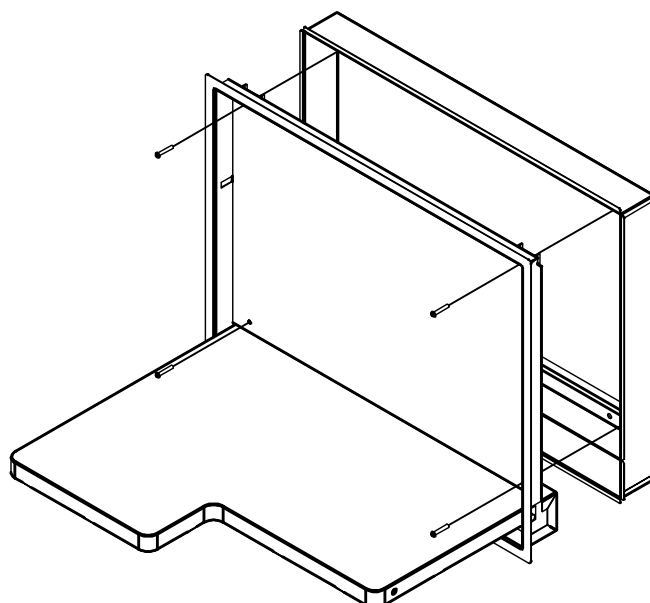
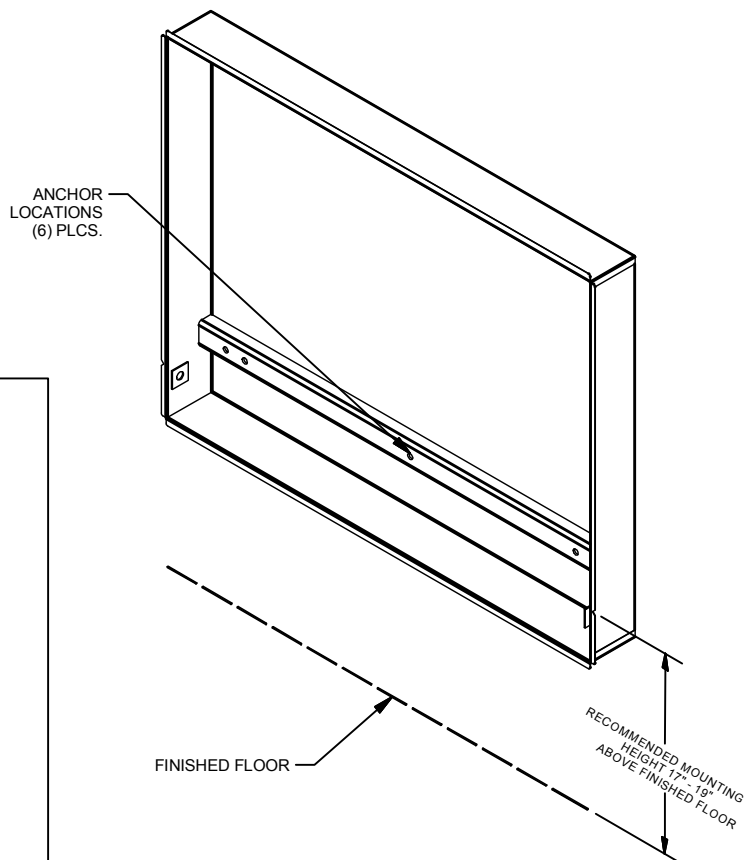

#### Assembly Notes

Norix is not responsible for any damage due to improper installation. If your shipment does not match the parts list, please contact: Norix Customer Service at 800-234-4900.

Norix reserves the right to modify design specifications at any time without an obligation to owners of previously sold products.

## For proper installation and to eliminate water seepage into the wall:

**NOTE:** Final Installation into wall requires a Silicone Caulk around entire Folding Seat Assembly.

**Product Required:** Eternabond, Webseal Waterproof Tape (20' required per complete unit) Manufacturers instructions must be followed. Also see Eternabond Tips and Installation Instructions ([http://www.eternabond.com/v/vspfiles/assets/images/eb\\_hvac\\_tips\\_install.pdf](http://www.eternabond.com/v/vspfiles/assets/images/eb_hvac_tips_install.pdf)).

### Wall Mount Assembly

2" X 2" Over Mounting Holes (6) Places

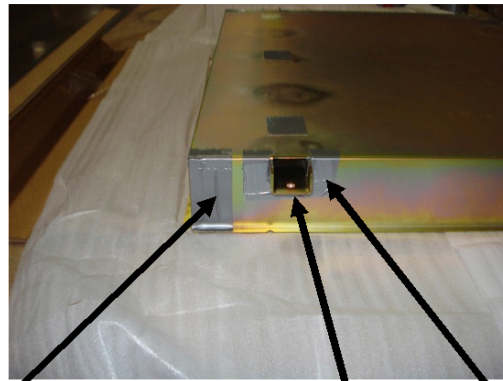
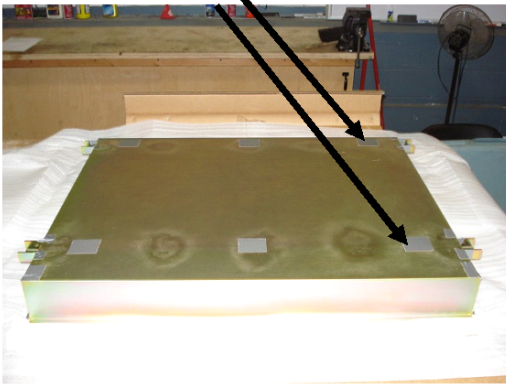

Cover Edge Flange Seams

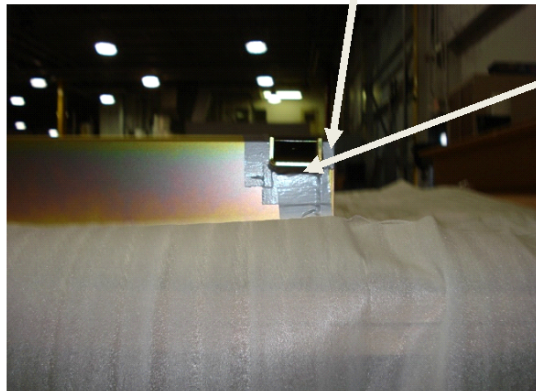

Cover Seams Under and Around U-Channel (4) Places

**Folding Seat Assembly**

Tape Top, Bottom, and Sides Being sure to cover seams

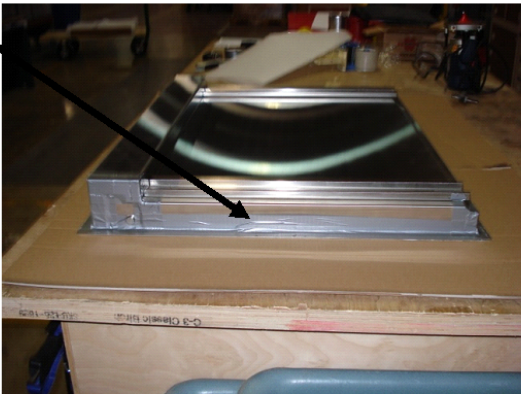
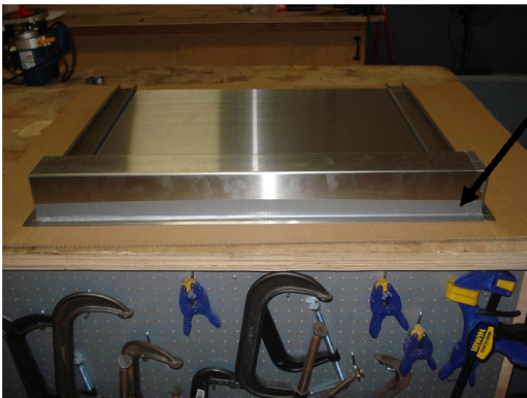

Cover Mounting Holes (4) Places

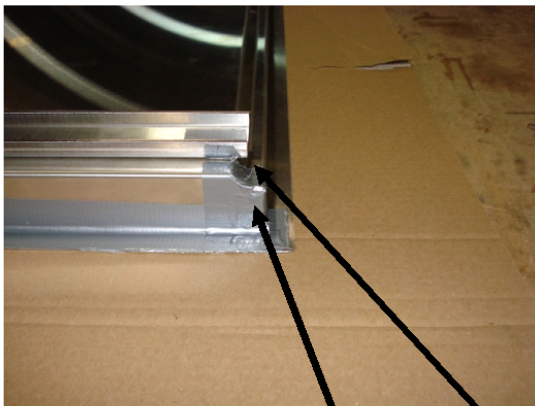
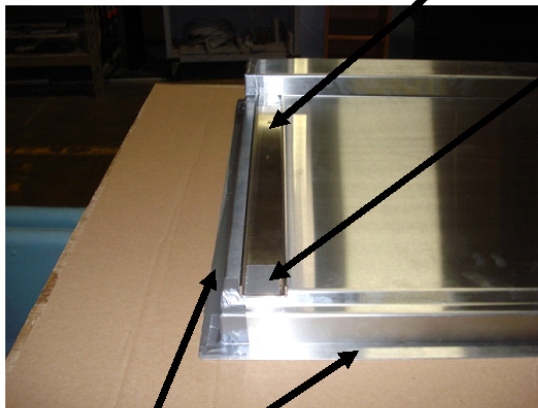

Apply Silicone Caulk Around entire flange (4) sides for final installation

Cover All Vertical and Horizontal Seams

